

SWING CHECK VALVES

PRESSURE SEAL COVER

SW/CH CLASS 600

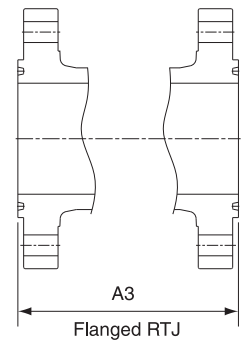
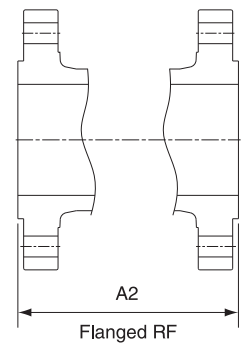
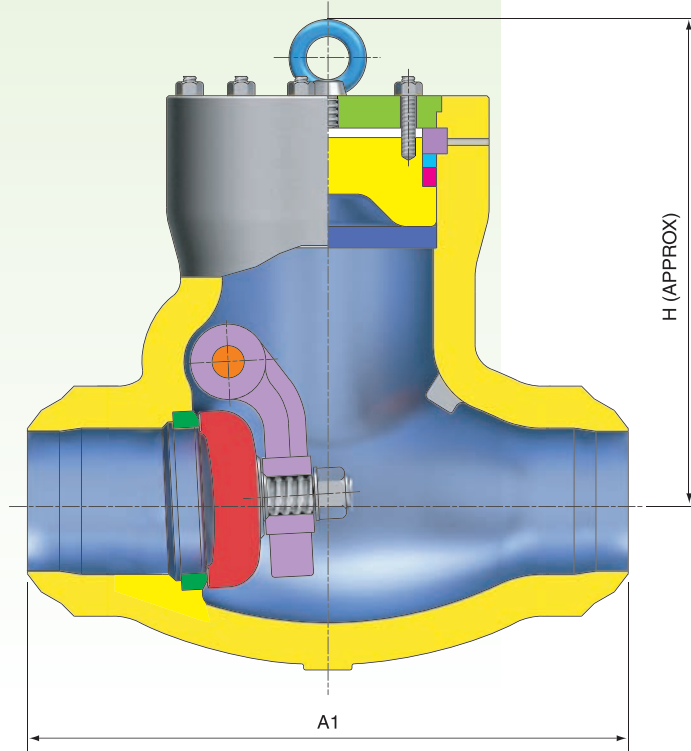
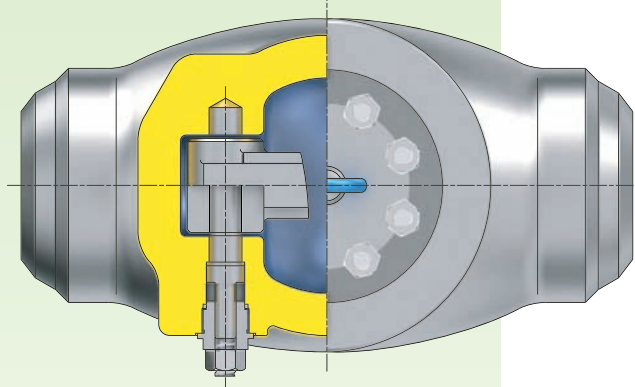

VALVE SIZE	in	2	2.5	3	4	6	8	10	12	14	16	18	20	24	
	mm	50	65	80	100	150	200	250	300	350	400	450	500	600	
A1	in	11.5	13.0	10.0	12.0	18.0	23.0	28.0	32.0	35.0	39.0	43.0	47.0	55.0	
	mm	292	330	254	305	457	584	711	813	889	991	1092	1194	1397	
A2	in	11.5	13.0	14.0	17.0	22.0	26.0	31.0	33.0	35.0	39.0	43.0	47.0	55.0	
	mm	292	330	356	432	559	660	787	838	889	991	1092	1194	1397	
A3	in	11.6	13.1	14.1	17.1	22.1	26.1	31.1	33.1	35.1	39.1	43.1	47.2	55.4	
	mm	295	333	359	435	562	663	790	841	892	994	1095	1200	1407	
H	in	11.4	13.5	8.1	10.2	12.8	17.1	23.9	27.4	29.5	28.7	28.7	32.2	37.4	
	mm	289	343	205	260	325	434	606	695	749	730	730	819	949	
WEIGHT	RF	lb	59.5	77.2	99.2	187.4	418.9	771.6	1102.3	1477.1	1940.0	2535.3	3262.8	4144.6	5731.9
		kg	27	35	45	85	190	350	500	670	880	1150	1480	1880	2600
	BW	lb	39.7	55.1	70.5	75.0	271.2	573.2	815.7	1080.2	1455.0	1873.9	2425.0	3284.8	4497.4
		kg	18	25	32	34	123	260	370	490	660	850	1100	1490	2040