



KH15 Series Pressure Transmitter

OUTLINE

This is detecting unit which used semiconductor strain gauge and the pressure transmitter which built-in electronic circuit and pressure is converted into electricity signal of 4-20mA DC, 0-5V DC or 1-5V DC, and transmit it. It is more compact compared with the product up to now, and is the product which let electric dependability, mechanical dependability improve.

FEATURES

- Because it adopts the sensing parts which used coating by vaporization type semiconductor strain gauge, there is durability, stability.
- Because there is not moving element, it is superior in vibration-proof impact resistance.
- It produces it from range 0.1MPa to 100MPa with identification mounting.
- It is high corrosion resistance to be using metal diaphragm. It can used liquid for wide applications.
- Electric dependability is high by hybrid IC of circuitry and is compact/light weight.

SPECIFICATION

- **Model :** KH15 Pressure Transmitter
- **Fluid :**
Gas or Liquid
- **Operating condition**
Please where there are no inflammable liquid or gas which may cause ignition or explosion under normal conditions.
- **Mounting (Case construction) :**
Terminal box (Small)
[Drip-proof type]
Terminal box (Large)
[Drip-proof type]
Connector type (Indoor use)
Connector type (Drip-proof type)
- **Connection :**
1/4"PF, 3/8"PF, 1/2"PF
1/4"PT, 3/8"PT, 1/2"PT
1/4"NPT, 3/8"NPT, 1/2"NPT
* The diaphragm type is available. Please contact us.
- **Head & Cover material :**
ADC12 with Silver plated
- **Wetted parts material :**
Diaphragm ----- 630SS (17-4PH)
Socket ----- 316SS
O-Ring ----- NBR
- **Pressure range :**
-0.1 ~ 2 MPa (Compound)
0 ~ 0.3 → 0 ~ 10 MPa
- **Accuracy :**
±1.0% F.S.
- **Operating temperature :**
-20 ~ 70°C
(0 ~ 70°C for range 0.1 MPa or Less)
- **Power source :**
24V DC±10%
- **Out put :**
4 ~ 20mA DC (2-wire type)
1 ~ 5V DC (3-wire type)
- **Transmission system :**
2-wire type or 3-wire type
- **Cable :**
0.2mm², 4 center core shield cable 2m,
diameter 6.2mm (Standard)
- **Zero & Span adjustment :**
Internal & External adjustment
- **Weight :**
Approx. 0.44kg

Outline dimension & Mounting type (KH15 Series)

KH15-□□□ (Small type)

| Model No. | d | f | h1 | h2 | h3 |
|-----------|--------|----|-----|-----|----|
| KH15-72 □ | PF1/4 | 16 | 135 | 104 | 63 |
| KH15-B2 □ | | | 140 | 112 | 68 |
| KH15-73 □ | | | 137 | 106 | 65 |
| KH15-B3 □ | PF3/8 | 18 | 142 | 114 | 70 |
| KH15-74 □ | | | 139 | 108 | 67 |
| KH15-B4 □ | PF1/2 | 20 | 144 | 116 | 72 |
| KH15-77 □ | | | 133 | 104 | 61 |
| KH15-B7 □ | PT1/4 | 16 | 135 | 110 | 66 |
| KH15-78 □ | | | 135 | 106 | 63 |
| KH15-B8 □ | | | 137 | 112 | 68 |
| KH15-79 □ | PT1/2 | 20 | 137 | 108 | 65 |
| KH15-B9 □ | | | 139 | 114 | 70 |
| KH15-7K □ | NPT1/4 | 16 | 133 | 104 | 61 |
| KH15-BK □ | | | 135 | 110 | 66 |
| KH15-7L □ | NPT3/8 | 18 | 135 | 106 | 63 |
| KH15-BL □ | | | 137 | 112 | 68 |
| KH15-7M □ | NPT1/2 | 20 | 137 | 108 | 65 |
| KH15-BM □ | | | 139 | 114 | 70 |

KH15 (Small type)

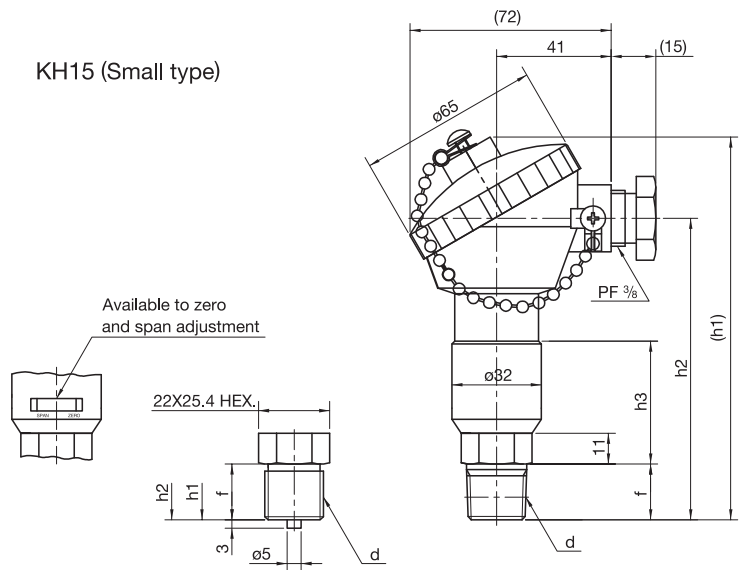

KH15-□□□ (Large type)

| Model No. | d | f | h1 | h2 | h3 |
|-----------|--------|----|-----|-----|----|
| KH15-92 □ | PF1/4 | 16 | 151 | 112 | 63 |
| KH15-D2 □ | | | 156 | 117 | 68 |
| KH15-93 □ | PF3/8 | 18 | 153 | 114 | 65 |
| KH15-D3 □ | | | 158 | 119 | 70 |
| KH15-94 □ | PF1/2 | 20 | 155 | 116 | 67 |
| KH15-D4 □ | | | 160 | 121 | 72 |
| KH15-97 □ | PT1/4 | 16 | 149 | 110 | 61 |
| KH15-D7 □ | | | 154 | 115 | 66 |
| KH15-98 □ | PT3/8 | 18 | 151 | 112 | 63 |
| KH15-D8 □ | | | 156 | 117 | 68 |
| KH15-99 □ | PT1/2 | 20 | 153 | 114 | 65 |
| KH15-D9 □ | | | 158 | 119 | 70 |
| KH15-9K □ | NPT1/4 | 16 | 149 | 110 | 61 |
| KH15-DK □ | | | 154 | 115 | 66 |
| KH15-9L □ | NPT3/8 | 18 | 151 | 112 | 63 |
| KH15-DL □ | | | 156 | 117 | 68 |
| KH15-9M □ | NPT1/2 | 20 | 153 | 114 | 65 |
| KH15-DM □ | | | 158 | 119 | 70 |

KH15 (Large type)

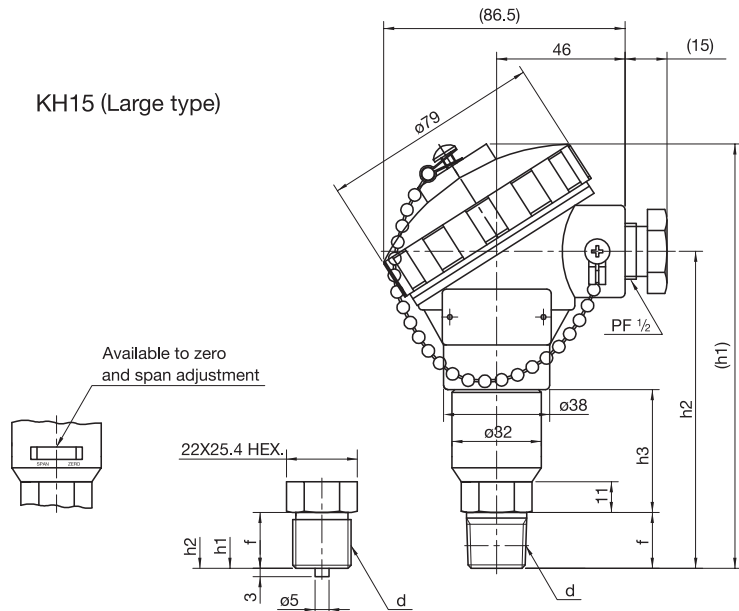

KH15-□□□ (Connector type)

| Model No. | d | f | h1 | h2 |
|-----------|--------|----|----|----|
| KH15-62 □ | PF1/4 | 16 | 71 | 55 |
| KH15-A2 □ | | | 76 | 60 |
| KH15-63 □ | PF3/8 | 18 | 73 | 55 |
| KH15-A3 □ | | | 78 | 60 |
| KH15-64 □ | PF1/2 | 20 | 75 | 55 |
| KH15-A4 □ | | | 80 | 60 |
| KH15-67 □ | PT1/4 | 16 | 71 | 55 |
| KH15-A7 □ | | | 76 | 60 |
| KH15-68 □ | PT3/8 | 18 | 73 | 55 |
| KH15-A8 □ | | | 78 | 60 |
| KH15-69 □ | PT1/2 | 20 | 75 | 55 |
| KH15-A9 □ | | | 80 | 60 |
| KH15-6K □ | NPT1/4 | 16 | 71 | 55 |
| KH15-AK □ | | | 76 | 60 |
| KH15-6L □ | NPT3/8 | 18 | 73 | 55 |
| KH15-AL □ | | | 78 | 60 |
| KH15-6M □ | NPT1/2 | 20 | 75 | 55 |
| KH15-AM □ | | | 80 | 60 |

KH15 (Connector type)

* Internal adjustment

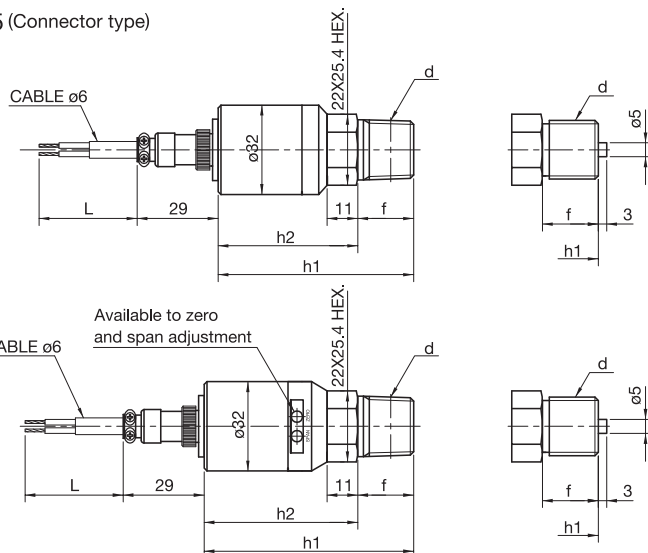

* External adjustment

Model number configuration (KH15 Series)

* For ordering, Please specify the model number and each spec.

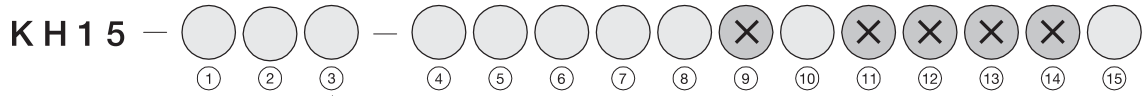

| Model number | | Selective spec. | | Option |
|----------------------------|---|------------------------------|--|--------|
| ① Type | 6 | Connector type | Internal adjustment (Zero & Span adjustment) | |
| | 7 | Terminal box type (Small) | Internal adjustment (Zero & Span adjustment) | |
| | 9 | Terminal box type (Large) | Internal adjustment (Zero & Span adjustment) | |
| | A | Connector type | External adjustment (Zero & Span adjustment) | |
| | B | Terminal box type (Small) | External adjustment (Zero & Span adjustment) | |
| | D | Terminal box type (Large) | External adjustment (Zero & Span adjustment) | |
| ② Connection | 2 | PF1/4 | | |
| | 3 | PF3/8 | | |
| | 4 | PF1/2 | | |
| | 7 | PT1/4 | | |
| | 8 | PT3/8 | | |
| | 9 | PT1/2 | | |
| | K | NPT1/4 | | |
| | L | NPT3/8 | | |
| | M | NPT1/2 | | |
| ③ Sealed type | 3 | O-ring type (NBR) | | |
| | | | | |
| ④ Pressure range (MPa) | 3 | -0.1~0.2, 0.3 (Compound) | | |
| | 4 | 0~0.3 | | |
| | 5 | -0.1~0.5, 1, 2 (Compound) | | |
| | 6 | 0~0.5, 1, 2 | | |
| | 7 | 0~3.5, 5, 10 | | |
| ⑤ Accuracy | 7 | ±1.0% F.S. | | |
| ⑥ Power source | 1 | 24V DC±10% | | |
| ⑦ Output | 1 | 4~20mA DC (2-Wire type) | | |
| | 2 | 1~5V DC (3-Wire type) | | |
| ⑧ Outlet for electric wire | C | Cable type | | |
| | 0 | Connector type | | |
| | 2 | Terminal box (Small) JIS 10b | | |
| | 4 | Terminal box (Large) JIS 15b | | |
| ⑩ Treatment | 0 | Nil | | |
| | 1 | Use no oil | | |
| | 2 | Use no water | | |
| | 3 | Use no oil & Water | | |
| ⑮ Document | 0 | Nil | | |
| | 1 | Required | | |