



GA10 Grade 0.5 Pressure Gauge

OUTLINE

This pressure gauge has been designed for high-precision applications and is equipped with a stainless steel bourdon tube. Its case is of dustproof type. As a gauge high-precision measurement research work, this pressure gauge is used for research and experiment, and for calibrating secondary gauges as a standard pressure gauge.

FEATURES

- A Bourdon tube of this gauge has been especially designed for high-precision applications. This bourdon tube is also provided with excellent corrosion resistance.
- To secure safety of operation in case this pressure gauge breaks during direct reading, a blowout disk window is provided as a standard.

- * In case of selecting pressure gauge, choose the pressure range which can be used in between 30~65% of full scale, so that the gauge can give its full capacity.
- * Also should be confirmed whether the wetted parts material is suitable for the fluid or not.
- * For oxygen service, please order us "USE NO OIL"
- * For acetylene service, please order us "USE NO OIL" with corrosion-proof.

SPECIFICATION

- **Model :** GA10 Grade 0.5 Pressure Gauge
- **Fluid :**
Gas or Liquid
- **Case construction :** Seal type
IP43 but not sealed completely.
- **Size :**
100 Dia.
- **Mounting :**
A type (Stem mounting)
B type (Surface wall mounting)
- **Connection :** Refer to the document "Screw for JIS pipe" in the technical sheet.
1/4"PF, 3/8"PF, 1/2"PF
1/4"PT, 3/8"PT, 1/2"PT
1/4"NPT, 3/8"NPT, 1/2"NPT
* For other connections, please contact us.
- **Wetted parts materials :**
Wetted parts generally mean the bourdon tube and socket.
Bourdon tube ----- 316SS
Socket (Shank) ----- 316SS
- **Case and Cover material :**
Aluminium with Black finish
- **Pressure range :**
0 ~ 0.1 → 0 ~ 5 MPa
-0.1 ~ 0 MPa
- **Accuracy :**
±0.5% F.S.
- **Operating temperature :**
Ambient : -5 ~ 40°C
Fluid : -20 ~ 80°C
- **Window :** Glass
- **Pointer :** Twist pointer
- **Blowout disk :**
When an emergency, bourdon tube exploded, it open up internal-pressure from blowout disk, and blowout disk prevents puncture of window.
Note : To keep normal function, please take a space behind of gauge at least 10mm when installing.
Don't process or stop up the blowout disk.
- **Weight :**
100 Dia. Approx. 0.65kg

Outline dimension & Mounting type (GA10 Series)

GA10-1□□

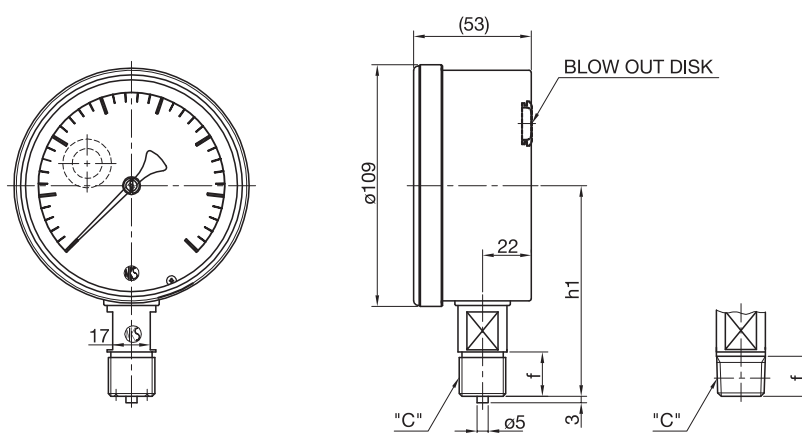

GA10-2□□

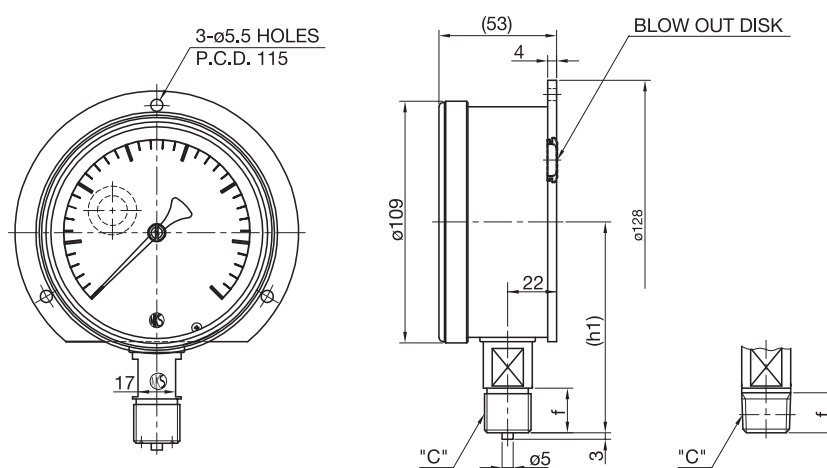

C	f	(h1)
PF1/4	16	92
PF3/8	18	94
PF1/2	20	95
PT1/4	14	92
PT3/8	16	94
PT1/2	18	96
NPT1/4	14	92
NPT3/8	16	94
NPT1/2	18	96

() = Reference dimension

Available pressure range table (GA10 Series)

Division	Scale (MPa)	Min. graduation	Std. accuracy (±% of F.S.)	Order code
Vacuum range	-0.1 ~ 0	0.001	0.5	A
Pressure range	0 ~ 0.1	0.001	0.5	C
	0 ~ 0.2	0.002	0.5	D
	0 ~ 0.3	0.005	0.5	E
	0 ~ 0.4	0.005	0.5	F
	0 ~ 0.6	0.005	0.5	H
	0 ~ 1	0.01	0.5	I
	0 ~ 1.5	0.02	0.5	J
	0 ~ 2	0.02	0.5	K
	0 ~ 2.5	0.02	0.5	L
	0 ~ 3.5	0.05	0.5	M
	0 ~ 5	0.05	0.5	N

Model number configuration (GA10 Series)

* For ordering, Please specify the model number and each spec.

GA **1** **0** — (1) (2) (3) — (4) (5) (6) (7) (8) (9) (10) (11) (12) (13) (14) (15)

Model		Selective spec.		Option	
Dial size	10	ø100			
① Type of mounting	1	A Type (Bottom connection)			
	2	B Type (Wall mounting connection)			
② Type of connection	1	NPT3/8			
	2	PF1/4			
	3	PF3/8			
	4	PF1/2			
	5	NPT1/4			
	6	NPT1/2			
	7	PT1/4			
	8	PT3/8			
	9	PT1/2			
③ Wetted parts material	2	304SS			
	3	316SS			
	0	Other			
④ Range (MPa)	A N	Refer to range table			
⑤ Accuracy	1	±0.5% F.S.			
⑥ Pointer	0	Standard			
	1	Other			
⑦ Glass	0	Standard			
	1	Other			
⑧ Treatment	0	Nil			
	1	Use no oil			
⑨ Throttle	0	Nil			
	1	FS10-011 or FS10-013 Corrosion-proof use			
	3	FS10-081 (With pipe)			
⑮ Documents	0	Nil			
	1	Required			